



615 SE ALDER, SUITE B  
PORTLAND, OR 97214  
BOOKING@GETDOWNPDX.COM

## HIGHLIGHTS

- **Up to 400 guests can be accommodated in the combined 6,900 square feet between bar and venue spaces**
- **Centralized and accessible location**
- **Newly constructed large private greenroom complete with bathroom and shower**
- **16x20 stage**
- **Completely renovated space**
- **Brand new HVAC system with plenty of vents throughout the space**



615 SE ALDER, SUITE B  
PORTLAND, OR 97214  
[BOOKING@GETDOWNPDX.COM](mailto:BOOKING@GETDOWNPDX.COM)

## PICTURES OF SPACE





## TECHNICAL SPECS

### SOUND

#### MAINS

- 2 Meyer Sound UPQ-D1's L/R (one per side)
- 1 Meyer Sound Ultra X40 Center Fill
- 2 Meyer Sound LCF 900 Subs
- 3 Meyer Sound Ultra X20 Delays+Bar Fill
- GALILEO GALAXY 408

#### FOH

- Allen and Heath Avantis
- Wi-Fi Router for iPad control

#### SNAKE

- Cat 6
- Installed Cat6 Ethernet run for digital snakes

#### MONITORS

- Note: monitors are run from FOH
- 4 EAW MW12 powered by LR 48M20 (bi-amped)
- 1 DB Tech DVX DM12 Stage monitor (active)
- 1 DB Tech DVX D12HP Drum top
- 1 DB Tech DVA S09-DP Drum sub
- \*\*Note we do not have an analog split in-house



## TECHNICAL SPECS

### MICROPHONES & DI'S

- **Microphones & DI's**
  - **(9) SM 58**
  - **(1) Beta 87a**
  - **(4) SM57**
  - **(4) Beta 57a**
  - **(2) e609**
  - **(1) Sennheiser 421**
  - **(1) EV P35**
  - **(3) e604**
  - **(3) Audix D3**
  - **(1) Audix D6**
  - **(1) Beta 52a**
  - **(1) Beta 91**
  - **(2) KSM 137**
  - **(1) J48 Active DI**
  - **(5) Radial Passive DI**
- 
- **DJ Equipment - None in house at this time**
  - **Backline - None in house at this time**





## Lighting

- **Mega-Lite Spot Bot CMY (x6)**
- **Mega-Lite MW1 (x10)**
- **ADJ Pocket Pro LED x4**
- **ADJ Saber Spot RGBW x4**
- **ADJ MB DMX2**
- **Radiance (or Le Maitre XS or MVS)**
- **Chamsys MQ50**
- **Half Mirror Ball**

## STAGE DIMENSIONS

- **16'x20', 30" tall**
- **Built with over 2 tons of sand, a half foot of rock wool, and eventually finished with carpet.**
- **Note: Risers are not permitted due to the low stage clearance**



615 SE ALDER, SUITE B  
PORTLAND, OR 97214  
BOOKING@GETDOWNPDX.COM

## FLOORPLAN

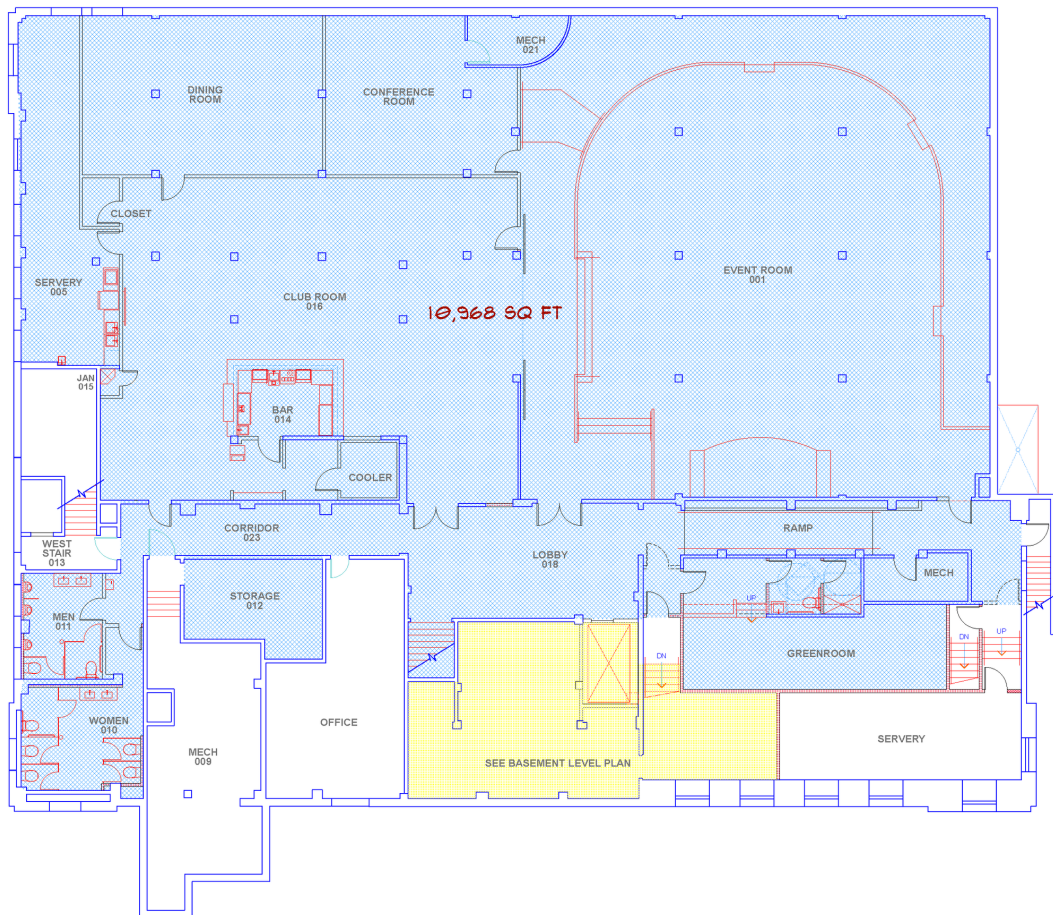



615 SE ALDER, SUITE B  
PORTLAND, OR 97214  
BOOKING@GETDOWNPDX.COM

## LOADING AND UNLOADING

- **There is a load in zone directly in front of the venue, which can be used for loading and unloading of equipment**
- **A service elevator is available for gear, which goes directly from the entrance to the venue level. Ramps are available to load equipment directly to the stage and storage.**
- **Secured, accessible, overnight bus parking is available for a \$40 fee. The lot can fit a full size tour bus**



615 SE ALDER, SUITE B  
PORTLAND, OR 97214  
BOOKING@GETDOWNPDX.COM

## PUBLIC TRANSPORTATION

**The Get Down is conveniently located on the inner East side of Portland, located one to two blocks from public transportation stops on Grand, MLK, Morrison and Belmont.**

### **Portland Street Car**

- **A & B Loop**
- **SE MLK and Morrison**
- **SE Grand and Belmont**

### **Bus lines**

- **6, 15, and 70**

### **MAX Light Rail**

- **Connects to Portland Street Car at:**
- ***Oregon Convention Center***
- **777 NE Martin Luther King Jr Blvd.**